

Basic Control Actuator

3476

Description

This device features a compact size and can be used in flush-mounted boxes, junction boxes, shutter boxes and ducts. Particularly advantageous is the installation inside junction boxes, positioning the item at the back of the flush-mounted box, behind lowered automation devices or behind conventional devices (pushbuttons, switches, etc.). This actuator/control accepts a traditional button with N/O contact on input. The control/actuation device has a BUS input made with blue cables, an input for connecting the external pushbutton via the grey and black cables and a relay contact for load control via the two white cables.

Technical data

Power supply via SCS BUS: 27 Vdc
 Operating power supply with SCS BUS: 18 – 27 Vdc
 Current draw: 13 mA
 Power/Consumption of driven loads:

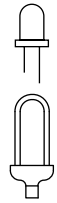
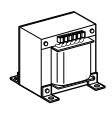
| | Incandescent lamps Halogen lamps | LED lamps Compact fluorescent lamps | Ferromagnetic transformers |
|---------|--|--|--|
| |  |  |  |
| 230 Vac | 460 W 2 A | 40 W Max. 1 lamp | 2 A cosφ 0.5 460 VA |

Dimensions

Size: basic module

Configuration

If the device is installed in a My Home system it can be configured in two ways:
 - PHYSICAL CONFIGURATION, inserting the configurators in position.
 - Configuration via MYHOME_Suite software package, downloadable from www.homesystems-legrandgroup.com; this mode has the advantage of offering many

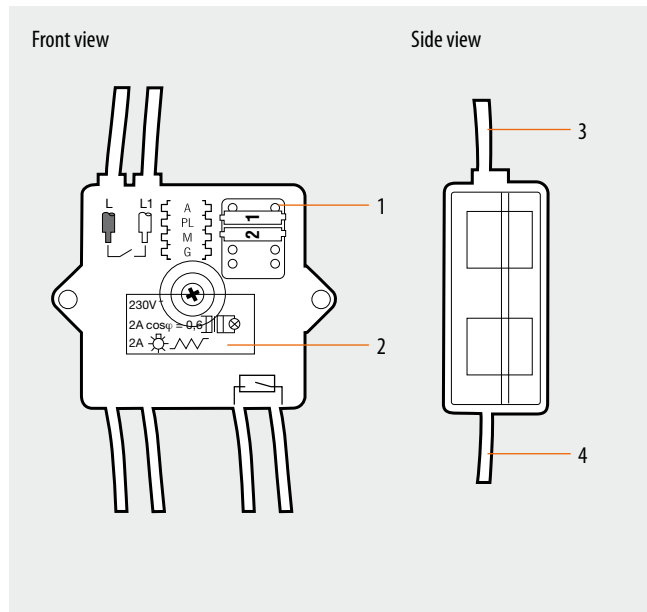

Legend

1. Configurator socket
2. LED
3. Cables 0.75 mm² for load connection
4. BUS

more options than the physical configuration.

For a list of the procedures and their meanings, please refer to the instructions on this sheet and to the "Glossary" section of the Guide to designing and installing My Home.

1.1 Addressing

| Address type | | Virtual configuration (MYHOME_Suite) | Physical configuration |
|----------------|----------------|--------------------------------------|------------------------|
| Point-to-point | Room | 0-10 | A=1-9 |
| | Lighting point | 0-15 | PL=1-9 |
| Group | | Group 1 - Group 10: 0-255 | G=0-9 |

1.2 Mode

| Virtual configuration (MYHOME_Suite) | | Physical configuration |
|---|-----------------------------|------------------------|
| Function | Parameter / setting | |
| Master Actuator | Master | M=0 |
| Actuator as Slave. Receives a control sent by a Master actuator with the same address | Slave | M=SLA |
| Pushbutton (ON monostable) ignores Room and General controls | Master PUL OFF Delay = 0 | M=PUL |

To use the "Actuator as a slave with PUL function", to select the type of load (Actuator, Lamp, Valve, Differential Reset, Fan, Irrigation, Controlled Outlet, Lock) use MYHOME_Suite virtual configuration.

1.2.1 ON/OFF control:

| Virtual configuration (MYHOME_Suite) | | Physical configuration |
|--------------------------------------|---|------------------------|
| Function | Parameter / setting | |
| | Cyclic. | M=0 |
| | ON | M=ON |
| | OFF | M=OFF |
| | ON with top button, OFF with bottom button. | M=0/I |
| Timed ON | 0.5sec | M=8 |
| | 30sec | M=7 |
| | 1min | M=1 |
| | 2min | M=2 |
| | 3min | M=3 |
| | 4min | M=4 |
| | 5min | M=5 |
| | 15min | M=6 |

NOTE: For timed ON with period 0 to 255 hours and "Timed OFF" control, use MYHOME_Suite virtual configuration